

2025 5th Avenue South Watermain Extension City of Fort Dodge Engineering Department 819 1ST AVE S FORT DODGE, IA		Approved _____ Date _____ Title _____
Designed Austin Morrow, PE	Drawn David Odor PLS	
Checked Austin Morrow PE		

GENERAL NOTES

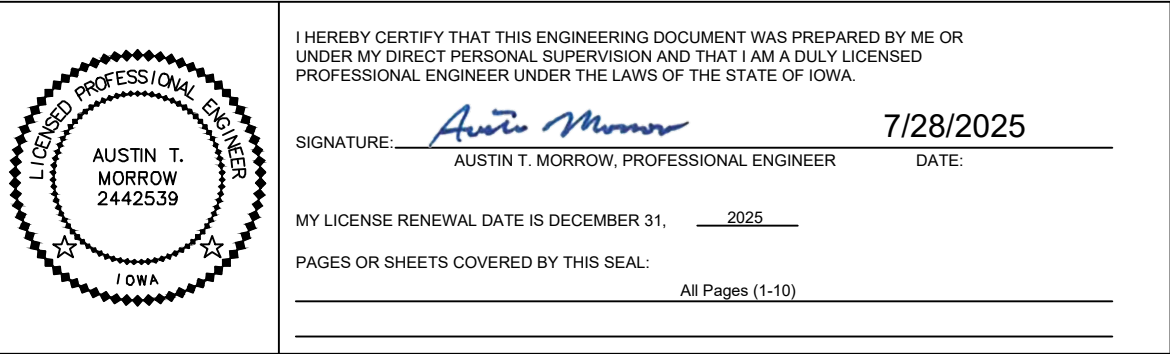

- | CITY OF FORT DODGE |  |
|--------------------|--|
| MAYOR:             | MATT BEMRICH   |
| COUNCIL:           | KIM ALSTOTT<br>JEN CRIMMINS<br>DAVID FLATTERY<br>QUENNEL MCALEB<br>CAMERON NELSON<br>LYDIA SCHUUR<br>MEGAN SECOR |
| FINANCE DIRECTOR:  | JEFF NEMMERS   |
| CHIEF DEVELOPMENT  |  |
| OFFICER:           | CHAD SCHAEFFER, P.E.   |
| CITY ENGINEER      | AUSTIN MORROW, P.E.  |



Date:	7-1-2025
Sheet A.1	

GENERAL NOTES:		PIPING NOTES:		Designed Austin Morrow, PE Drawn David Odor PLS Checked Austin Morrow PE	2025 5th Avenue South Watermain Extension City of Fort Dodge Engineering Department 819 1ST AVE S FORT DODGE, IA	Approved _____ Title _____	
1. THE LOCATION OF KNOWN EXISTING UNDERGROUND UTILITIES ARE SHOWN ON THE DRAWINGS AND ARE BELIEVED TO BE ESSENTIALLY CORRECT. NO GUARANTEE IS MADE RELATIVE TO THE COMPLETENESS OR ACCURACY AND THE CONTRACTOR IS REQUIRED TO CONTACT THE REGISTERED UTILITY PROTECTION SERVICE AND THE OWNERS OF EACH UNDERGROUND UTILITY FIXTURE/SYSTEM SHOWN ON THE DRAWINGS AT LEAST THREE WORKING DAYS PRIOR TO COMMENCING CONSTRUCTION IN ANY AREA.		1. ALL PIPING SHALL BE SLOPED UNIFORMLY BETWEEN GIVEN ELEVATIONS UNLESS APPROVED OTHERWISE. WHERE UNIFORMLY SLOPED PIPING IS NOT FEASIBLE, THE CONTRACTOR SHALL PROVIDE VERTICAL BEND OR OFFSETS AS NECESSARY. REALIGNMENT SHALL BE APPROVED BY THE ENGINEER PRIOR TO INSTALLATION.					GENERAL NOTES
2. ALL EXISTING UTLITES, SERVICES, POLES, AN CONNECTIONS SHALL BE PROTECTED A THE CONTRACTOR'S EXPENSE. IF DAMAGE IS CAUSED BY CONTSTRUCTION TO ANY EXISTING UTILITY, THE CONTRACTOR SHALL BE RESPONSIBLE FOR THE REPAIR OR RESTORATION OF THE SAME, IN ACCORDANCE WITH THE DIRECTIONS OF THE ENGINEER.		2. PIPING WITHIN EXCAVATION SHALL BE ADEQUATELY SUPPORTED WITH HAUNCHES, SUPPORT BEAMS, FILL CONCRETE, AS SHOWN, OR COMPACTED CLASS 1 MATERIAL AS APPROVED BY THE ENGINEER. YARD PIPING ACROSS TRENCH EXCAVATIONS SHALL BE ADEQUATELY SUPPORTED WITH COMPACTED CLASS 1 MATERIAL OR CLASS C CONCRETE PER IDOT, AS APPROVED BY THE ENGINEER.					
3. THE CONTRACTOR SHALL EXPOSE ALL UTILITIES, OR STRUCTURES PRIOR TO CONSTRUCTION TO VERIFY THE VERTICAL AND HORIZONTAL LOCATION OF THE UTLITY, OR STRUCTURE AND ITS EFFECT ON THE NEW CONSTRUCTION. THE CONTRACTOR SHALL COORDINATE WITH THE UTILITY TO SUPPORT POLES OR FACILITIES, AS NECESSARY, AS APPROVED BY THE UTILITY.		3. DISTURBED AREAS THROUGH NEW AND EXISTING SEEDED AREAS SHALL BE GRADED AND SEEDED AS SPECIFIED.					
4. OSHA PROHIBITS CRANE AND BACKHOE OPERATIONS WITHIN 10 FEET OF ENERGIZED PRIMARY CONDUCTORS, TEMPORARY RELOCATION OF ELECTRICAL UTLITIES, INCLUDING RESTRAINT OF POLES, RELOCATION OF POLES, AND RUBBER COVERING OF ENERGIZED CONDUCTORS MAY BE REQUIRED. THE COORDINATION AND COST OF THESE SERVICES IS THE RESPONSIBILITY OF THE CONTRACTOR. THE CONTRACTOR MAY RESTRAIN POLES IF THE METHOD OF SURPPORT HAS BEEN SUBMITTED TO AND APPROVED BY THE UTILITY OWNER.		4. PIPING SHALL HAVE A MINIMUM COVER OF 5 FEET 6 INCHES UNLESS OTHERWISE SHOWN.					
5. ANY EXISTING PROPERTY CORNER PINS OR MONUMENTS DAMAGED OR DESTROYED BY CONSTRUCTION SHALL BE RESET BY THE CONTRACTOR AT THE CONTRACTOR'S EXPENSE UPON COMPLETION OF THE PROJECT AND PRIOR TO FINAL PAVEMENT. A CERTIFICATION SHALL BE FURNISHED BY A LICENSED SURVEYOR, STATING THAT SAID PINS AND MONUMENTS HAVE BEEN RESTORED.		5. LOCATIONS OF EXISTING PIPING, AS SHOWN ON PLANS, ARE DETERMINED FROM FIELD SURVEYS AND AVAILABLE RECORDS, AND ARE APPROIMATE. CONTRACTOR SHALL FIELD VERIFY, AS NECESSARY. IF NEW ALIGNMENT CONFLICTS WITH THE EXISTING PIPING THE CONTRACTOR SHALL SUBMIT REVISED LAYOUT TO ENGINEER FOR APPROVAL PRIOR TO PROCEEDING WITH INSTALLATION.					
6. THE CONTRACTOR SHALL FIELD VERIFY ALL EXISITNG ELEVATIONS AND DIMENSIONS AND MAKE ADJUSTMENTS ACCORDINGLY UNDER THE DIRECTION OF THE ENGINEER.		6. AT SANITARY AND STORM CROSSINGS, WATER PIPE SHALL BE LOCATED SO BOTH JOINTS WILL BE AS FAR FROM THE SEWER CROSSING AS POSSIBLE.					
7. REMOVE AND STOCKPILE ALL TOPSOIL PRIOR TO ANY EXCAVATION, TOPSOIL RESPREAD SHALL BE PLACED AT A MINUMUM THICKNESS OF 8 INCHES AND IS INCIDENTAL TO THE CONSTRUCTION.		7. A MINIMUM 18-INCH VERTIAL CLEARANCE (MEASURED OUT-TO-OUT CLEAR) BETWEEN ANY NEW WATER LINE AND ANY EXISTING SANITARY SEWER OR STORM SEWER MUST BE MAINTAINED.					
8. THE CONTRACTOR IS RESPONSIBLE FOR THE DISPOSAL OF ALL CONSTRUCTION DEBRIS INCLUDING, BUT NOT LIMITED TO, EXCESS SOIL, ROCK, OR ANY OTHER TYPE MATERIALS. THE CONTRACTOR SHALL NOT FILL ANY WETLANDS, LOWLANDS, FLOOD PLAINS, OR DRAINAGE WAYS WITH SAID DEBRIS WITHOUT OBTAINING THE PROPER APPROVALS, PERMITS, LICENSES, ETC. FROM LOCAL, STATE, OR FEDERAL AGENCIES.		8. ANY NEW PIPING INSTALLED UNDERNEATH STRUCTURES SHALL BE INSTALLED WITH A MINIMUM 8-INCH CLASS 'C' CONCRETE ENCASEMENT. THIS APPLIES TO ALL STRUCTURES AND PIPING WHETHER SHOWN AS ENCASED OR NOT.					
9. ALL DISTURBED AREAS OUTSIDE OF THE WALKS, DRIVES, AND STRUCTURES SHALL BE SEEDED AND MULCHED AFTER THE AREAS HAVE BEEN FINISHED, GRADED, AND TOPSOIL HAS BEEN ADDED. FINAL SEEDING AND MULCHING SHALL BE IN ACCORDANCE WITH SUDAS SPECIFICATION SECTION 9010.		9. ANY THRUST BLOCKS NECESSARY SHALL BE IN ACCORDANCE WITH SUDAS SECTION 5010 AND ARE INCIDENTAL TO CONSTRUCTION.					
10. THE CONTRACTOR SHALL SUPPLY ALL LABOR, MATERIAL, AND EQUIPMENT NECESSARY TO MAINTAIN ROADWAYS BEING USED NEAR THE CONSTRUCTION SITE.		10. IF A TRACER WIRE IS PRESENT THE CONTRACTOR SHALL REPAIR OR CONNECT THE TRACER WIRE AS NECESSARY TO MAINTAIN A COMPLETE CIRCUIT. CONTRACTOR SHALL COORDINATE TESTING OF TRACER SYSTEM WITH CITY STAFF AS SECTIONS OF PIPE ARE COMPLETED AND AVAILABLE. THE FULL SYSTEM SHALL BE TESTED AND PASS PRIOR TO FINAL RESTORATION OR PAVING ACTIVITIES.					
11. RESTORE DISTURBED AREAS TO PRECONSTRUCTION CONDITION.		11. ALL VALVES, FITTINGS, AND APPURTENANCES SHALL BE RESTRAINED JOINT AND IS INCIDENTAL TO THE RESPECTIVE BID ITEM.					
12. CONTRACTOR SHALL PROVIDE ONE MARK-UP SET OF RECORD DRAWINGS TO THE ENGINEER AT THE COMPLETION OF THE PROJECT. THE MARK-UP SET MUST BE NEAT AND LEGIBLE AND MUST DOCUMENT ALL DEVIATIONS FROM THE ORIGINAL CONTRACT DOCUMENTS. RECORD DRAWINGS MUST BE SUBMITTED PRIOR TO FINAL PAYMENT.		12. ALL PIPE, VALVES, FITTINGS, APPURTENANCES, AND PLUGS SHALL BE GPS RECORDED USING SURVEY GRADE EQUIPMENT AND IS INCIDENTAL TO THE RESPECTIVE BID ITEM.					
13. CONTRACTOR SHALL BE RESPONSIBLE FOR PROVIDING TEMPORARY UTILITIES AS REQUIRED FOR COMPLETION OF WORK AT ANY NEW OR EXISTING STRUCTURE.		13. ALL PIPE, VALVES, FITTINGS, AND APPURTENANCES AS INDICATED IN SPECIFIC AREAS SHALL USE NITRILE GASKETS AND IS INCIDENTAL TO THE RESPECTIVE BID ITEM.					
14. THE CONTRATOR SHALL ENSURE THAT ALL WATER AND SANITARY PIPE ENDS SHALL BE CLOSED WITH A WATERTIGHT PLUG AT ANY TIME THE SITE IS NOT OCCUPIED.		CONFLICTING UTILITIES NOTES:					
15. THE CONTRACTOR SHALL PROVIDE SUPPORT TO ANY EXISTING UTLITY OR SERVICE LINE THAT IS EXPOSED IN AN OPEN TRENCH.		1. ALL EXISTING UTILITIES, SERVICES, POLES, AND CONNECTIONS SHALL BE PROTECTED AT THE CONTRACTOR'S EXPENSE. IF DAMAGE IS CAUSED TO ANY EXISTING UTILITY, THE CONTRACTOR SHALL BE RESPONSIBLE FOR THE REPAIR OR RESTORATION, IN ACCORDANCE WITH THE DIRECTIONS OF THE UTILITY.					
16. ALL TRENCHES SHALL BE BACKFILLED AT THE END OF EACH WORKDAY EXCLUDING THE END OF THE PIPE WHERE WORK WILL BEGIN THE NEXT DAY.		2. EXISTING OR NEW PIPING WITHIN ANY EXCAVATION SHALL BE ADEQUATELY SUPPORTED USING CLASS R-2 BEDDING FOR ALL RIGID PIPE AND CLASS F-3 FOR ALL FLEXIBLE PIPING.					
17. ALL OPEN TRENCHES EXCEEDING 6 FEET IN DEPTH MUST BE PROTECTED BY ORANGE SAFETY FENCE WHEN THE SITE IS NOT OCCUPIED.		3. ALL STORM OR SANITARY SEWERS DAMAGED SHALL BE REPAIRED AT THE EXPENSE OF THE CONTRACTOR. LOCATIONS SHALL BE PROVIDED TO THE ENGINEER FOR NOTATION IN AS-BUILT DRAWINGS. IF A CROSS CONNECTION IS FOUND THE ENGINEER SHALL BE NOTIFIED IMMEDIATELY.					
18. ALL OSHA TRENCHING AND SHORING REQUIREMENTS SHALL BE MET AND ARE INCIDENTAL TO THEIR RESPECTIVE BID ITEMS.		4. CONTRACTOR SHALL BE RESPONSIBLE FOR PROVIDING TEMPORARY UTILITIES AS REQUIRED FOR COMPLETION OF WORK AT ANY NEW OR EXISTING STRUCTURE.					
		5. ALL DIMENSIONS SHALL BE VERIFIED IN THE FIELD PRIOR TO ORDERING OF EQUIPMENT, MATERIALS, AND OTHER PRODUCTS. THIS INCLUDES THE DIAMETER OF SEWER MAINS CIPP LINING MATERIALS AND NEW MANHOLES.					
		DEMOLITION & DISPOSAL NOTES:					
		1. THE CONTRACTOR IS RESPONSIBLE FOR DISPOSAL OF ALL CONSTRUCTION DEBRIS INCLUDING, BUT NOT LIMITED TO, EXCESS SOIL, ROCK, OR ANY OTHER TYPE MATERIALS. THE CONTRACTOR SHALL NOT FILL ANY WETLANDS, LOWLANDS, FLOOD PLAINS, OR DRAINAGE WAYS WITH SAID DEBRIS WITHOUT OBTAINING PROPER APPRIVALS, PERMITS, LICENSES, ETC. FROM LOAL, STATE, OR FEDERAL AGENCIES.					
		2. THE OWNER SHALL HAVE FIRST RIGHT TO ANY SALVAGEABLE MATERIALS. SALVAGED MATERIAL TO BE RETAINED BY OWNER SHALL BE DELIVERED TO THE OWNER AND BE INCIDENTAL TO THE RESPECTIVE BID ITEM.					
				Date: 7-1-2025			
				Sheet B.1			

ESTIMATE REFERENCE INFORMATION						ESTIMATE REFERENCE INFORMATION					
ITEM NO.	ITEM CODE	ITEM	DESCRIPTION	QUANTITY	UNIT	ITEM NO.	ITEM CODE	ITEM	DESCRIPTION	QUANTITY	UNIT
1	2010-1.08-D-1	TOPSOIL, ON-SITE	ITEM INCLUDES BUT NOT LIMITED TO, STRIPPING AND STOCKPILING TOPSOIL; PREPARING THE TOPSOIL PLACEMENT AREA BY TILLAGE OR RIPPING; RE-SPREADING THE TOPSOIL; ADDITIONAL TILLAGE TO ADDRESS COMPACTION DURING PLACEMENT; AND REMOVAL OF CLODS, ROOTS, STONES, AND OTHER UNDESIRABLE MATERIALS. EXCESS TOPSOIL CAN BE WASTED ONSITE BY PROVIDING ADDITIONAL THICKNESS. ITEM WILL BE PAID PER PLAN QUANTITY WITH NO MEASURMENT MADE.	1110	CY	12	9010-108-B	HYDRAULIC SEEDING, SEEDING, FERTILIZING, AND HYDROMULCH (TYPE 2)	SEEDING, FERTILIZING, AND MULCHING FOR HYDRAULIC SEEDING; ITEM INCLUDES, BUT IS NOT LIMITED TO, REMOVAL OF ROCK AND OTHER DEBRIS; REPAIRING RILLS AND WASHES; PREPARING THE SEEDBED; FURNISHING AND PLACING FERTILIZER AND MULCH; AND FURNISHING WATER AND OTHER CARE DURING THE CARE PERIOD, FOR ALL DISTURBED AREAS, SUDAS TYPE 1 (PERMANENT LAWN MIXTURE) AND SOWN DURING SUDAS SPECIFIED DATES.	1	AC
2	3010-108-D	REPLACEMENT OF UNSUITABLE BACKFILL MATERIALS	MEASUREMENT WILL BE IN CUBIC YARDS FOR THE QUANTITY OF BACKFILL MATERIAL REQUIRED TO REPLACE UNSUITABLE MATERIAL REMOVED DURING STANDARD TRENCH EXCAVATION. MEASRUEMENT WILL BE BASED ON COMPACTED MAERIAL IN PLACE. PAYMENT WILL BE AT THE UNIT PRICE PER CUBIC YARD FOR THE QUANTITY OF BACKFILL MATERIAL FURNISHED. UNIT PRICE INCLUDES, BUT IS NOT LIMITED TO, FURNISHING, HAULING, AND PLACING BACKFILL MATERIAL. THIS ITEM WILL ONLY BE USED WHEN NEEDED AND AUTHORIZED BY THE ENGINEER.	75	CY	13	11020-108-1	MOBILIZATION	INCLUDES, BUT IS NOT LIMITED TO THE MOVEMENT OF PERSONNEL, EQUIPMENT, AND SUPPLIES TO THE PROJECT SITE; ESTABLISHMENT OF OFFICES, BUILDINGS, AND OTHER FACILITES NECESSSARY FOR THE PROJECT; BONDING, PERMITS, OR OTHER EXPENSES INCURRED PRIOR TO CONSTRUCTION.	1	LS
3	3010-108-F	TRENCH COMPACTION TESTING	ITEM INCLUDES COMPACTION TESTING PER SUDAS 3010. THIS INCLUDES , BUT IS NOT LIMITED TO, ALL PAYMENTS ASSOCIATED WITH THE LUMP SUM PRICE FOR TRENCH COMPACTION TESTING, INCLUDING ALL PAYMENTS ASSOCIATED WITH RETESTING RESULTING FROM FAILURE OF INITIAL TESTS.	1	LS	14	-	CONTINGENCY	CONTINGENCY FOR UNFORSSSEN CIRCUMSTANCES DUE TO SUBGRADE AND UTILITY ISSUES THAT ARE NOT EVIDENT FROM THE ORIGINAL DESIGN AND DEVELOPMENT PERSPECTIVE OF THE PROJECT.	1	LS
4	5010-108-A-1	WATER MAIN, TRENCHED, PVC, 12 IN. DIA.	WATER MAIN, TRENCHED, PVC, 12 IN. DIA., INCLUDES, BUT IS NOT LIMITED TO, TRENCH EXCAVATION; DEWATERING; FURNISHING AND INSTALLING PIPE; CONNECTING TO EXISTING PIPE; FURNISHING, PLACING, AND COMPACTING BEDDING AND BACKFILL MATERIAL; TRACER SYSTEM; TESTING; DISINFECTIONS; AND POLYETHYLENE WRAP FOR DUCTILE IRON PIPE AND FOR FITTINGS. PIPE BEDING CLASS - P1.	2000	LF						
5	5010-108-A-1	WATER SERVICE STUB, TRENCHLESS, COPPER, 2 IN. DIA.	SERVICE LOCATIONS ARE APPROXIMATE. FINAL LOCATION TO BE COORDINATED WITH PROPERTY OWNER. ITEM INCLUDES, BUT IS NOT LIMITED TO, SERVICE TAP; SERVICE CORPORATION; SERVICE PIPE; CURB STOP; STOP BOX; TRENCHLESS EXCAVATION PIT ESTABLISHMENT; DEWATERING; FURNISHING AND INSTALLING TRENCHLESS PIPE; FURNISHING, PLACING, AND COMPACTING BEDDING AND BACKFILL MATERIAL; TRACER SYSTEM; TESTING; AND DISINFECTIONS.	2	EA						
6	5010-108-C-2	FITTINGS BY WEIGHT, DUCTILE IRON PIPE	EACH TYPE AND SIZE OF FITTING INSTALLED AS SPECIFIED IN THE CONTRACT DOCUMENTS OR AS REQUIRED FOR PROPER INSTALLATION OF THE WATER MAIN WILL BE COUNTED. DETERMINE THE TOTAL WEIGHT OF FITTINGS COUNTED, IN POUNDS, BASED ON THE STANDARD FITTING WEIGHTS PUBLISHED IN AWWA C 153 FOR DUCTILE IRON FITTINGS. PAYMENT WILL BE MADE A THE UNIT PRICE PER POUND FOR EACH TYPE AND SIZE OF FITTING. ALL FITTINGS SHALL BE RESTRAINED JOINT TYPE. RESTRAINED JOINTS AND THRUST BLOCKS ARE INCIDENTAL TO THIS BID ITEM. ANCHOR TEE FOR HYDRANTS IS INCLUDED UNDER FIRE HYDRANT ASSEMBLY ITEM.	612	LBS						
7	-	CONNECT TO EXISTING WATER MAIN	ITEM INCLUDES ALL MATERIALS, EQUIPMENT, AND LABOR TO REMOVE AN EXISTING 12" PLUG AND CONNECT THE NEW WATER MAIN TO THE EXISTING 12" TEE. WORK TO BE IN ACCORDANCE WITH SUDAS DIVISION 5.	1	EA						
8	5020-108-C	FIRE HYDRANT ASSEMBLY	ITEM INCLUDES, BUT IS NOT LIMITED TO, THE FIRE HYDRANT, BARREL EXTENSTIONS SUFFICIENT TO ACHIEVE PROPERY BURY DEPTH OF ANCHORING PIPE AND HEIGHT OF FIRE HYDRANT ABOVE FINISHED GRADE, AND COMPONENTS TO CONNECT THE FIRE HYDRANT TO THE WATER MAIN, INCLUDING ANCHORING PIPE, FITTINGS, THRUST BLOCKS, PEA GRAVEL OR POROUS BACKFILL MATERIAL, AND FIRE HYDRANT GATE VALVE AND APPURTENANCES. HYDRANT SHALL BE MUELLER SUPER CENTURION 250, CATALOG #A-423 OR KENNEDY K81D; 5-1/4" MAIN VALVE, 3-WAY, FORT DODGE THREADS, 1" SQUARE OPERATING NUT, TWO 2-1/2" HOSE NOZZLES, ONE 4-1/2" PUMPER NOZZLE, AND SHOP COAT YELLOW.	4	EA						
9	5020-108-A	GATE VALVE / BOX ASSEMBLY - 12 IN. DIA.	ITEM INCLUDES, BUT IS NOT LIMITED TO, ALL COMPONENTS ATTACHED TO THE VALVE OR REQUIRED FOR ITS COMPLETE INSTALLATION, INCLUDING UNDERGROUND OR ABOVE GROUND OPERATION, SQUARE VALVE OPERATING NUT, VALVE BOX AND COVER, VALVE BOX EXTENSION, AND VALVE STEM EXTENSION. BUTTERFLY VALVES AE NOT ALLOWED.	3	EA						
10	7030-108-H-A	DRIVEWAY, GRANULAR, 6 IN	ITEM INCLUDES REMOVAL AND REPLACEMENT OF 6" GRANULAR SURFACING FOR ACEESS DRIVES. THE AREA OF MANHOLES, OR OTHER FIXTURES WILL NOT BE DEDUCTED FROM THE MEASURED GRAVEL AREA. PAYMENT WILL BE AT THE UNIT PRICE PER SQUARE YARD FOR 6" THICKNESS OF GRANULAR SURFACING PLACED. UNIT PRICE INCLUDES, BUT NOT LIMITED TO EXCAVATION AND SUBGRADE PREPARATION, AS WELL AS REMOVAL AND DISPOSAL OR EXISTING GRANULAR DRIVES.	30	SY						
11	8030-108-A	TEMPORARY TRAFFIC CONTROL	ITEM INCLUDES INSTALLATION, MAINTENANCE, AND REMOVAL OF TEMPORARY TRAFFIC CONTROL FOR THE DURATION OF THE PROJECT. CONTRACTOR SHALL FURNISH, ERECT, OPERATE, MOVE, REMOVE, AND MAINTAIN TRAFFIC CONTROL DEVICES AT ALL TIMES DURING THE EXECUTION OF WORK UNTIL FINAL PROJECT ACCEPTANCE. ALL TRAFFIC CONTROL TO BE IN ACCORDANCE WITH THE MUTCD, SUDAS, AND WEBSTER COUNTY PERMIT REQUIREMENTS. EXISTING PERMANENT TRAFFIC CONTROL DEVICES THAT CONFLICT WITH THE TEMPORARY TRAFFIC CONTROL SHALL BE REMOVED OR COVERED FOR THE DURATION OF THE PROJECT.	1	LS						

Designed Austin Morrow, PE

Drawn David Odor PLS

Checked Austin Morrow PE

2025 5th Avenue South Watermain Extension

City of Fort Dodge Engineering Department  
819 1ST AVE S  
FORT DODGE, IA

Approved \_\_\_\_\_  
Title \_\_\_\_\_





















REFERENCE INFORMATION & QUANTITIES

GENERAL NOTES

Date:  
7—1—2025

Sheet B.2

## GENERAL LEGEND

	OVERHEAD ELECTRIC		POWER POLE
	UNDERGROUND FIBER OPTIC		WATER VALVE
	GAS MAIN OR SERVICE		FIRE HYDRANT
	WATER MAIN		GUY WIRE / ANCHOR
	WATER SERVICE		HICKENBOTTOM AREA INTAKE
	STORM MAIN OR CULVERT		STORM SEWER INTAKE
	CONTOUR LINES INTERMEDIATE		TELEPHONE PEDESTAL
	CONTOUR LINES INDEX		FIBER JUNCTION BOX
	PROPERTY LINE		TRAFFIC SIGNAL BASE
	SECTION LINE - ROAD CENTERLINE		GRAVEL DRIVE

<div style="text-align: center;"> <h2 style="margin: 0;">2025 5th Avenue South Watermain Extension</h2> <p style="margin: 5px 0;">City of Fort Dodge Engineering Department 819 1ST AVE S FORT DODGE, IA</p> </div>		Designed Austin Morrow, PE Drawn David Odor PLS Checked Austin Morrow PE
<div style="text-align: center;"> <h2 style="margin: 0;">LEGEND</h2> </div>		Approved _____ Date _____ Title _____
GENERAL NOTES		
Date: 7-1-2025		
Sheet B.3		

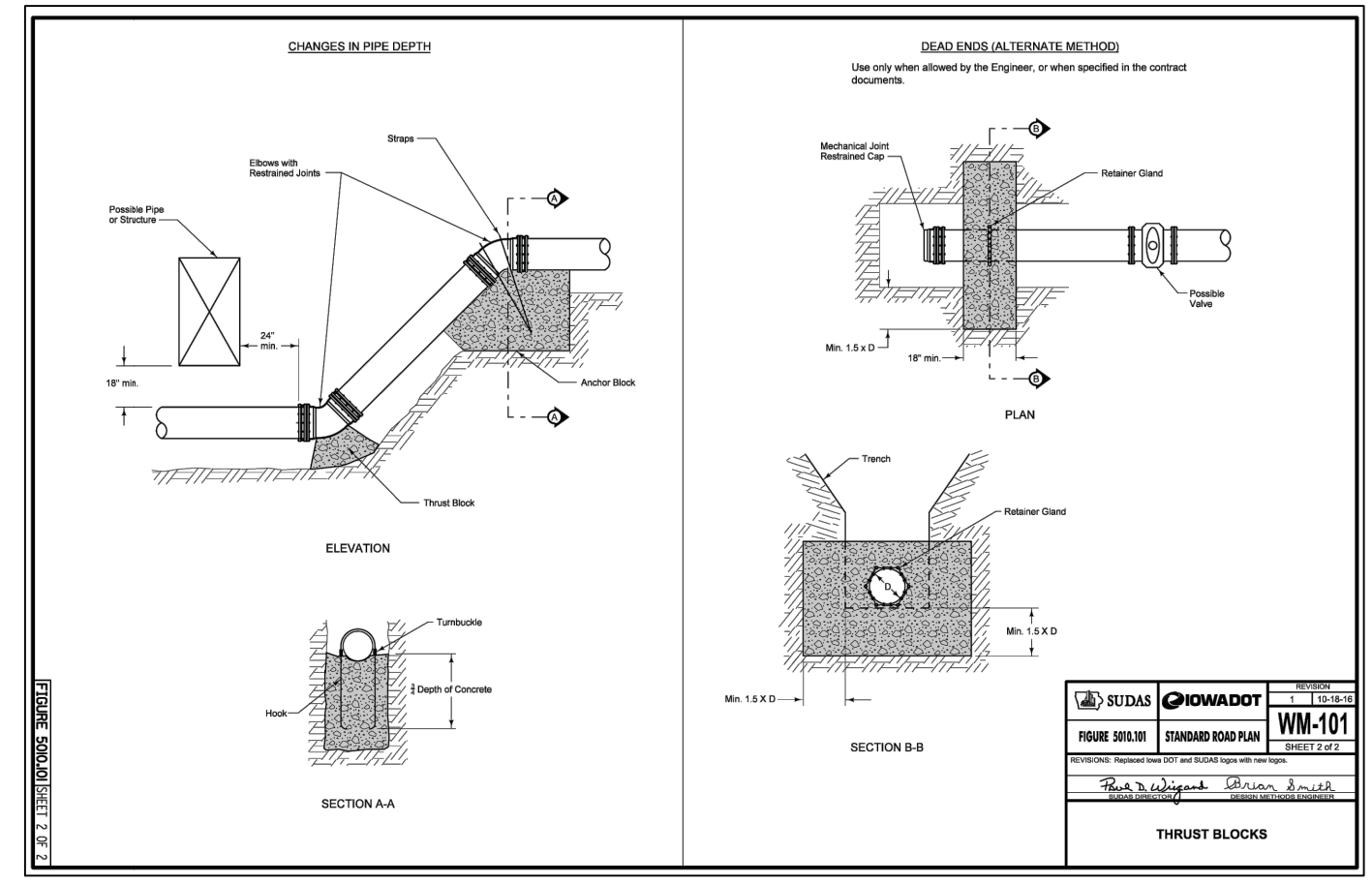
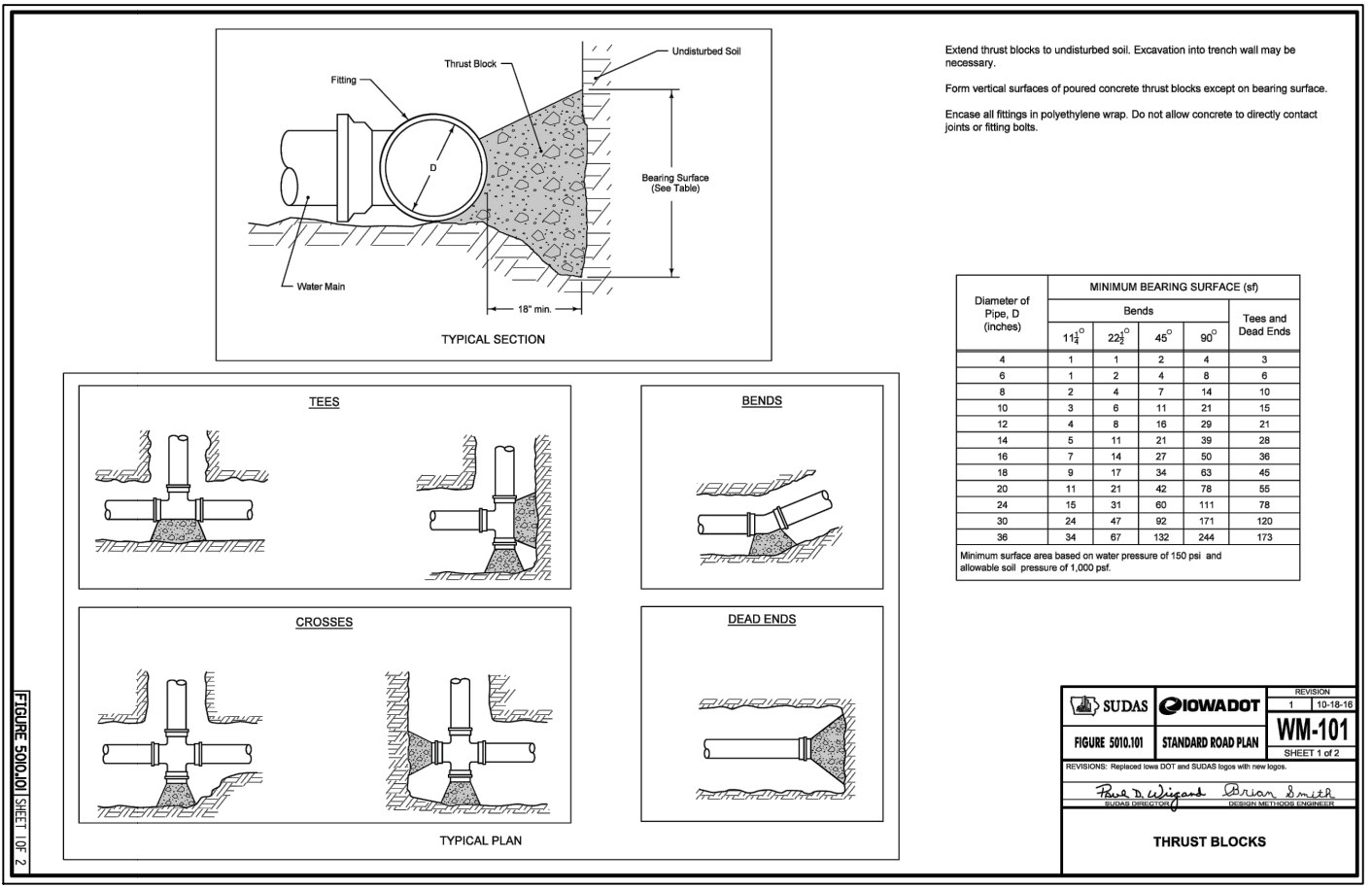
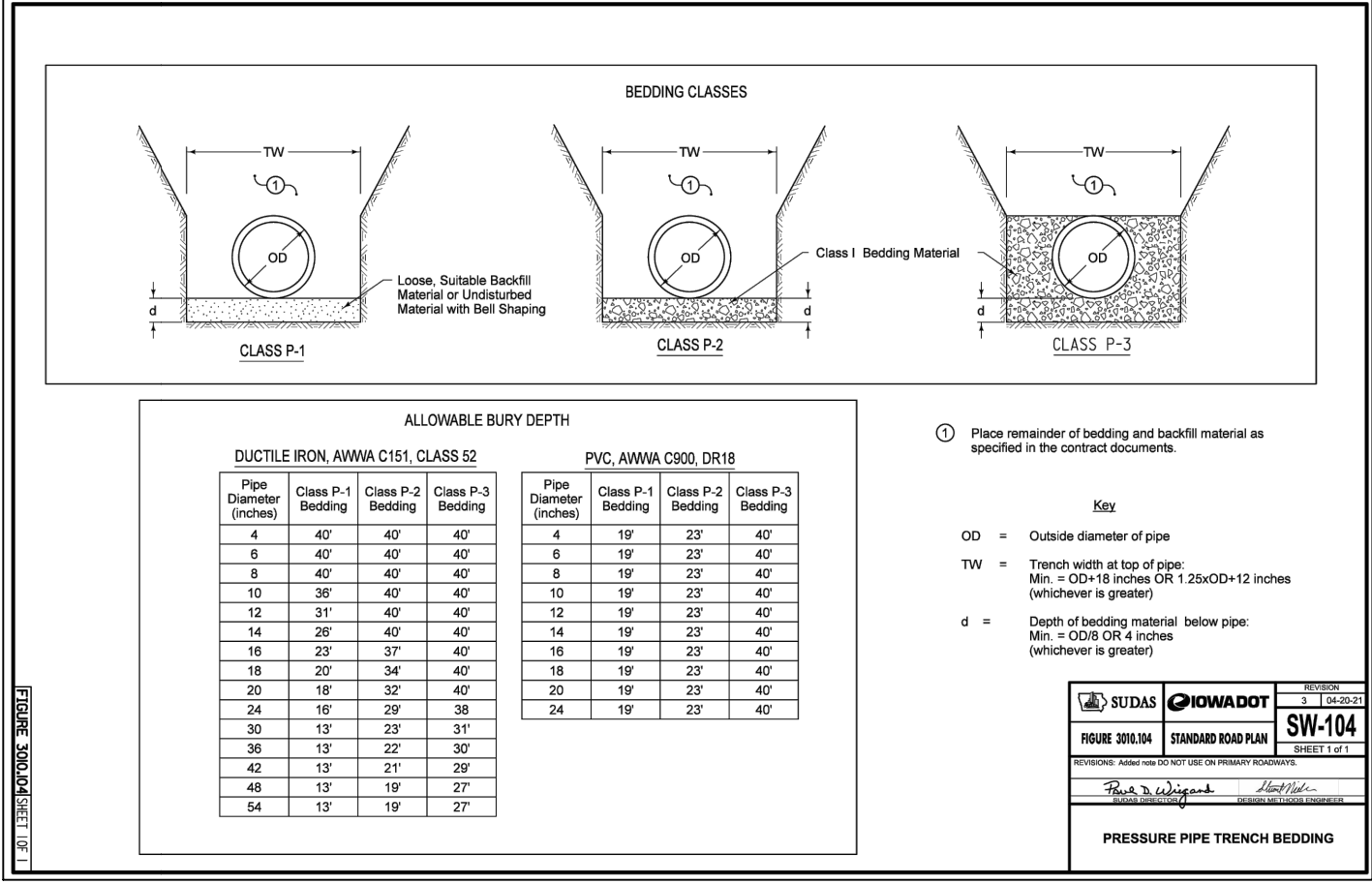
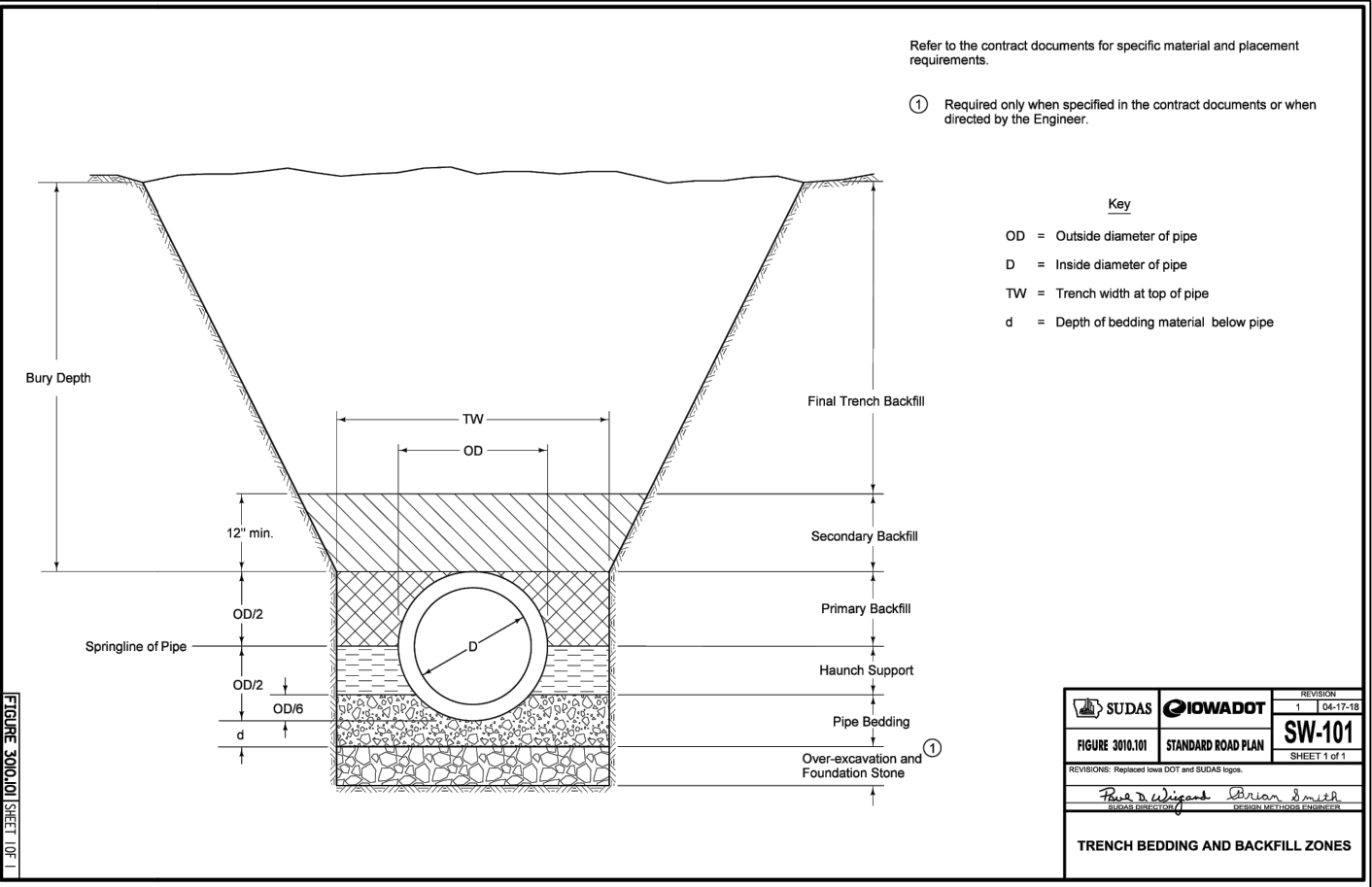

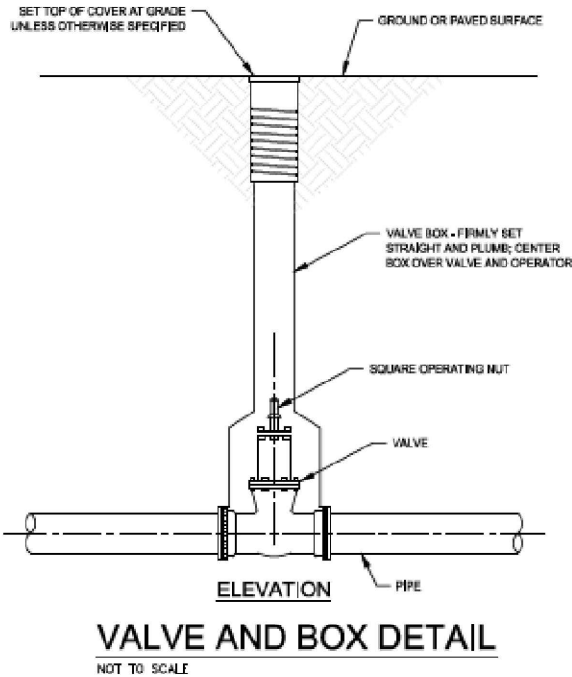
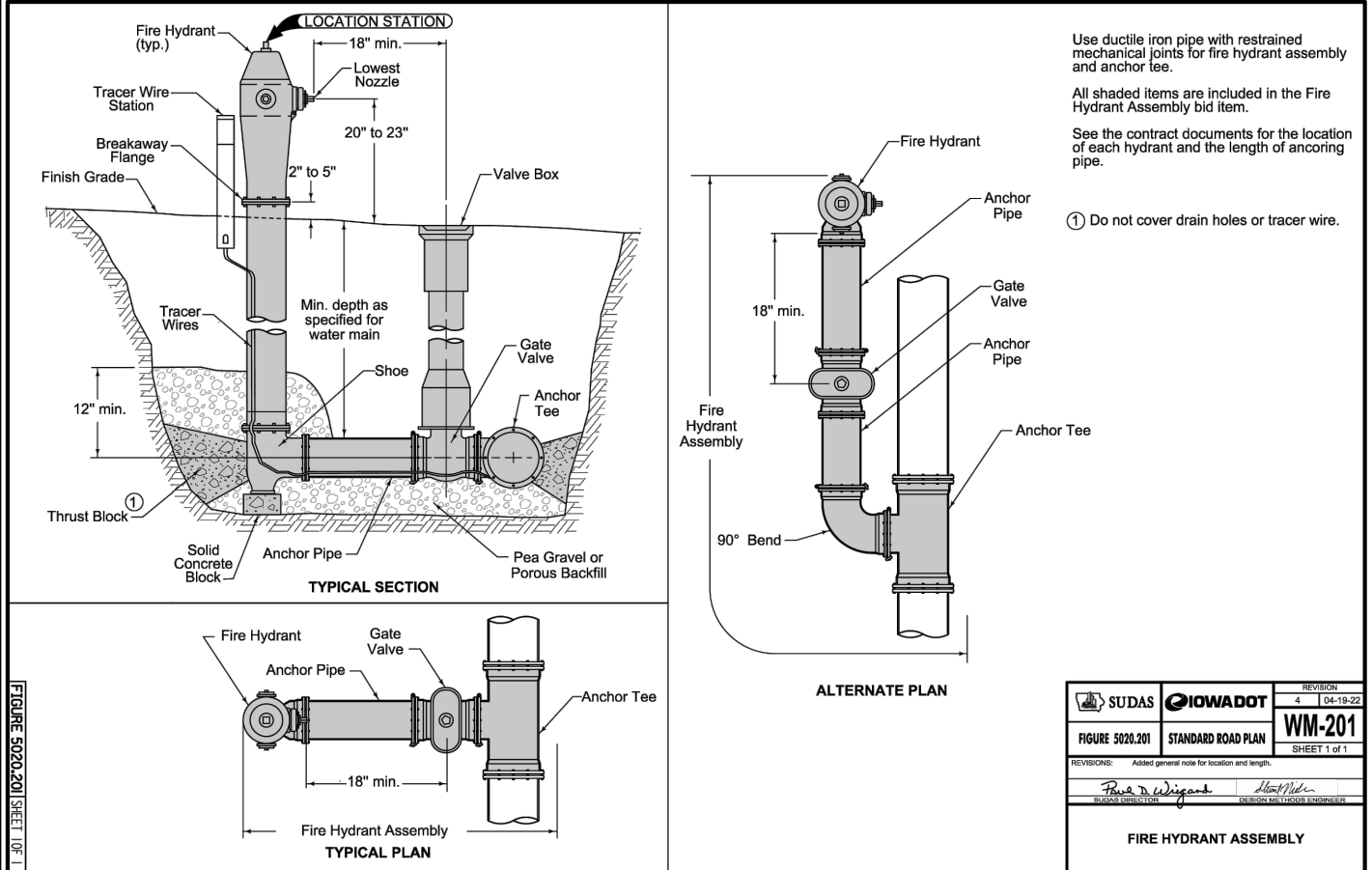
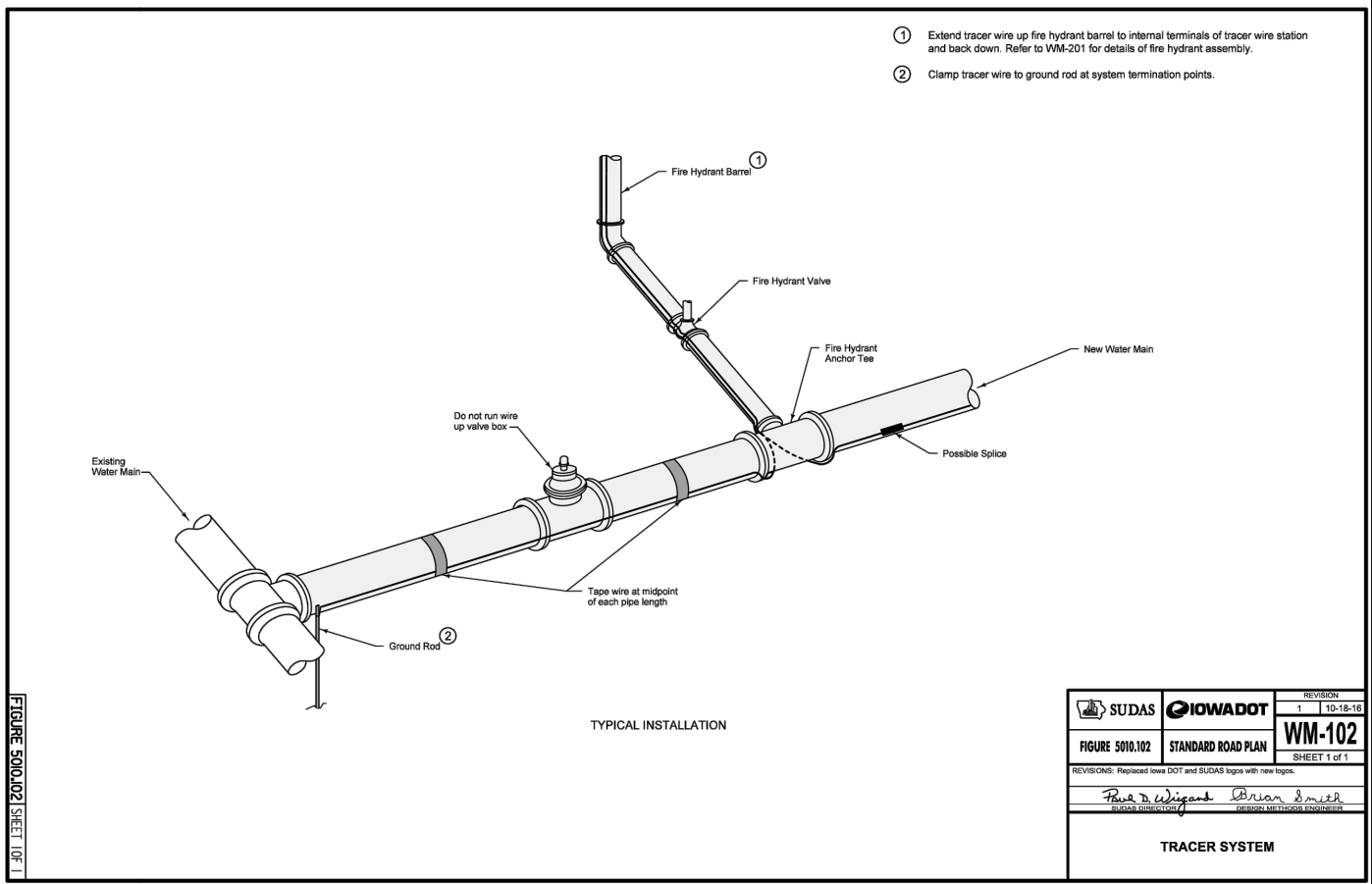

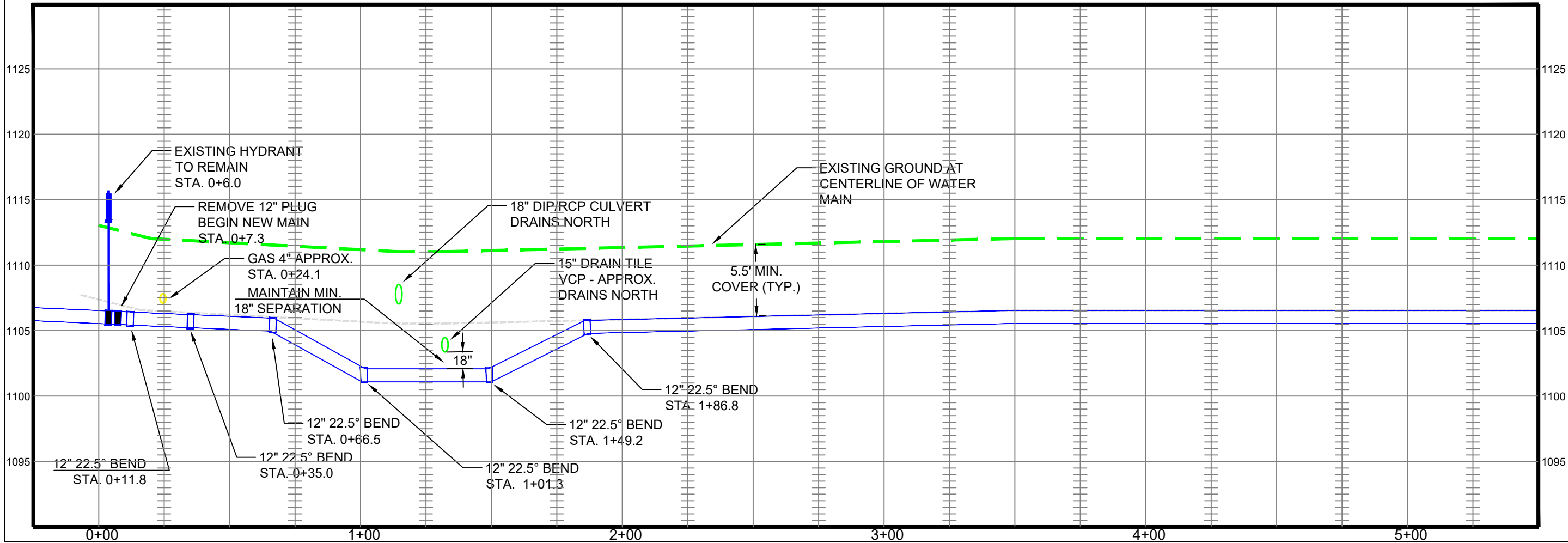
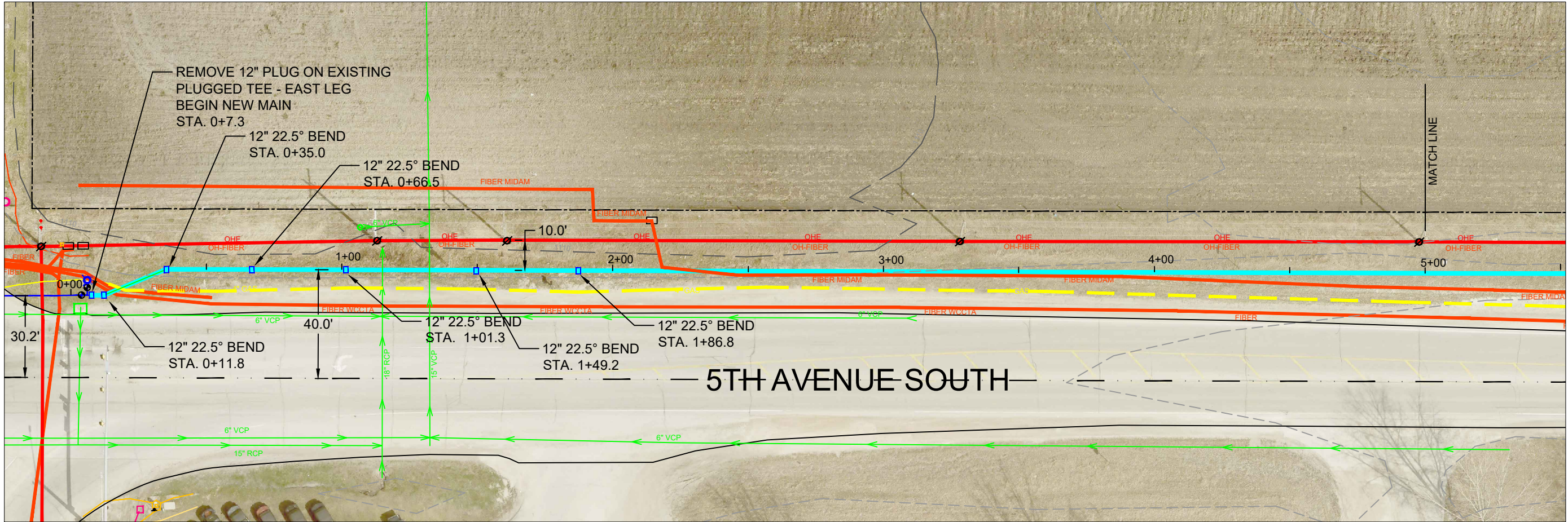

2025 5th Avenue South Watermain Extension		Designed Austin Morrow, PE
City of Fort Dodge Engineering Department		Drawn David Odor PLS
819 1ST AVE S		Checked Austin Morrow PE
FORD DODGE, IA		
Water Plan & Profile		Approved _____ Date _____
		Title _____
GENERAL NOTES		
Date: 7-1-2025		
Sheet D.1		

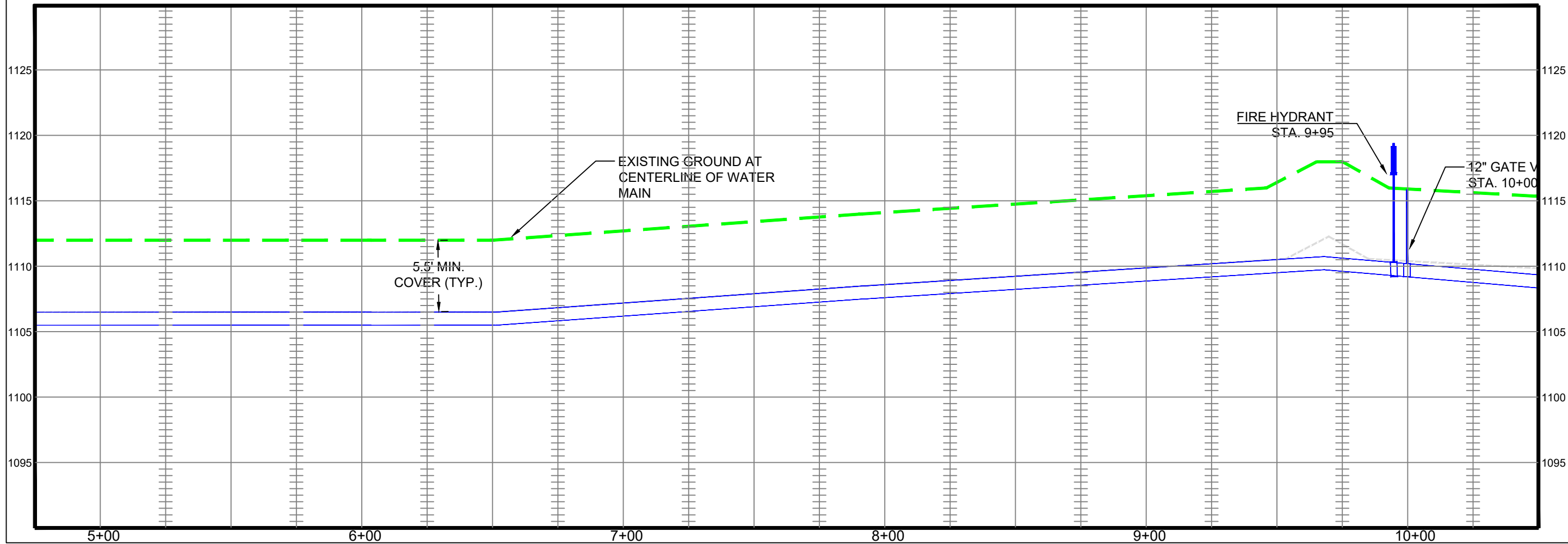

2025 5th Avenue South Watermain Extension City of Fort Dodge Engineering Department 819 1ST AVE S FORT DODGE, IA		Designed Austin Morrow, PE
		Drawn David Odor PLS
		Checked Austin Morrow PE
Water Plan & Profile		Approved _____ Date _____ Title _____
GENERAL NOTES		
Date: 7-1-2025		
Sheet D.2		

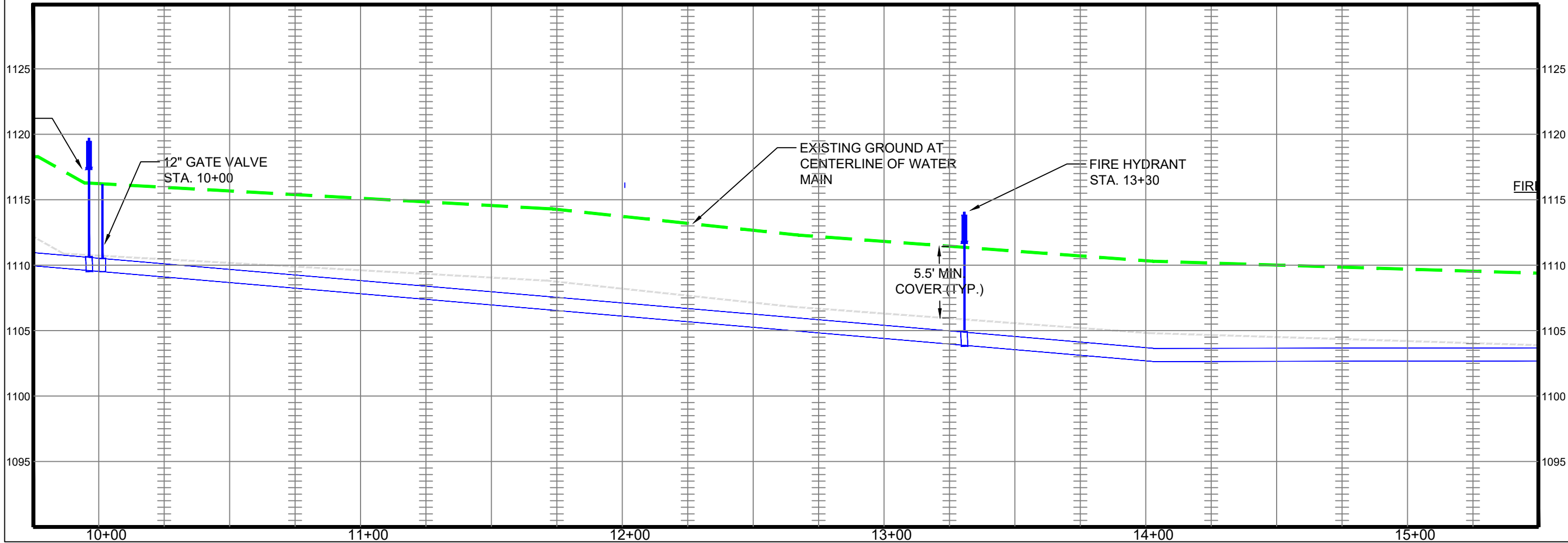
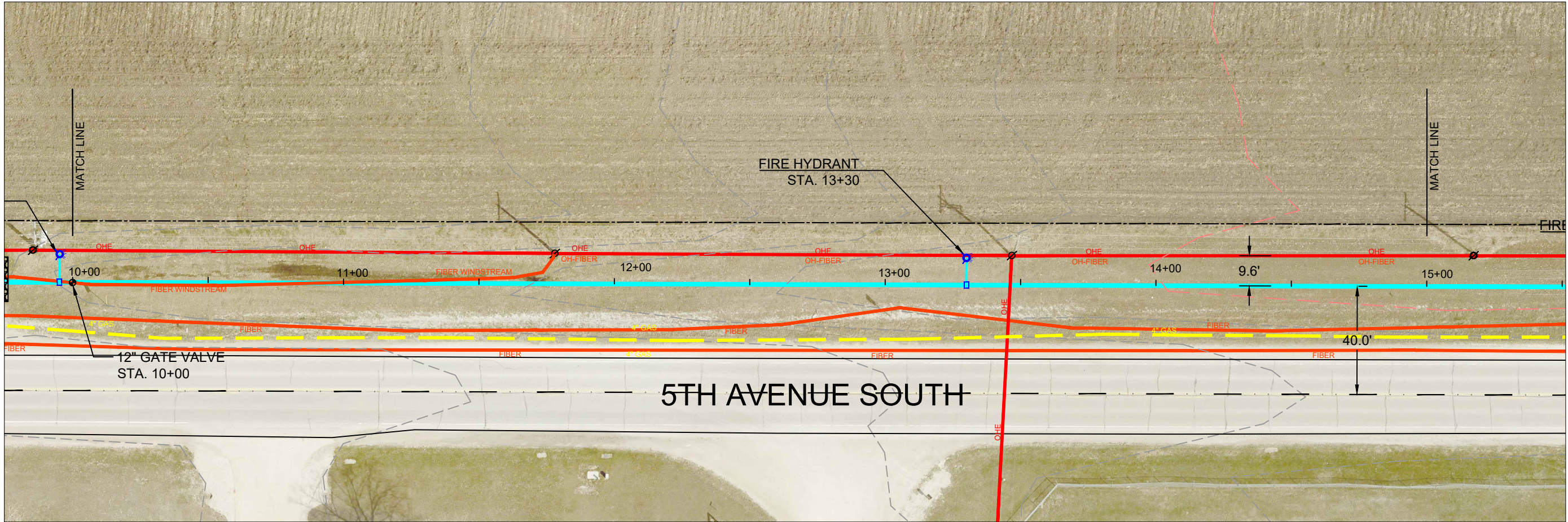

2025 5th Avenue South Watermain Extension City of Fort Dodge Engineering Department 819 1ST AVE S FORT DODGE, IA	Designed Austin Morrow, PE
	Drawn David Odor PLS
	Checked Austin Morrow PE
Water Plan & Profile	Approved _____ Date _____
	Title _____
GENERAL NOTES	
Date: 7-1-2025	
Sheet D.3	

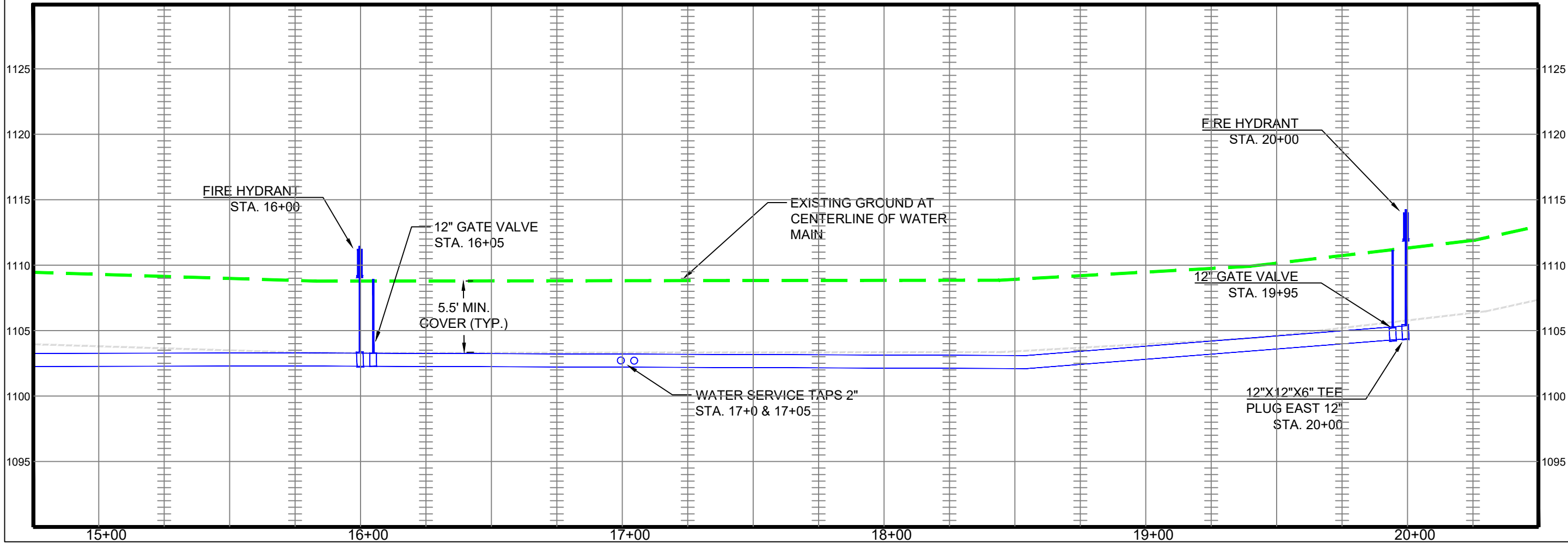
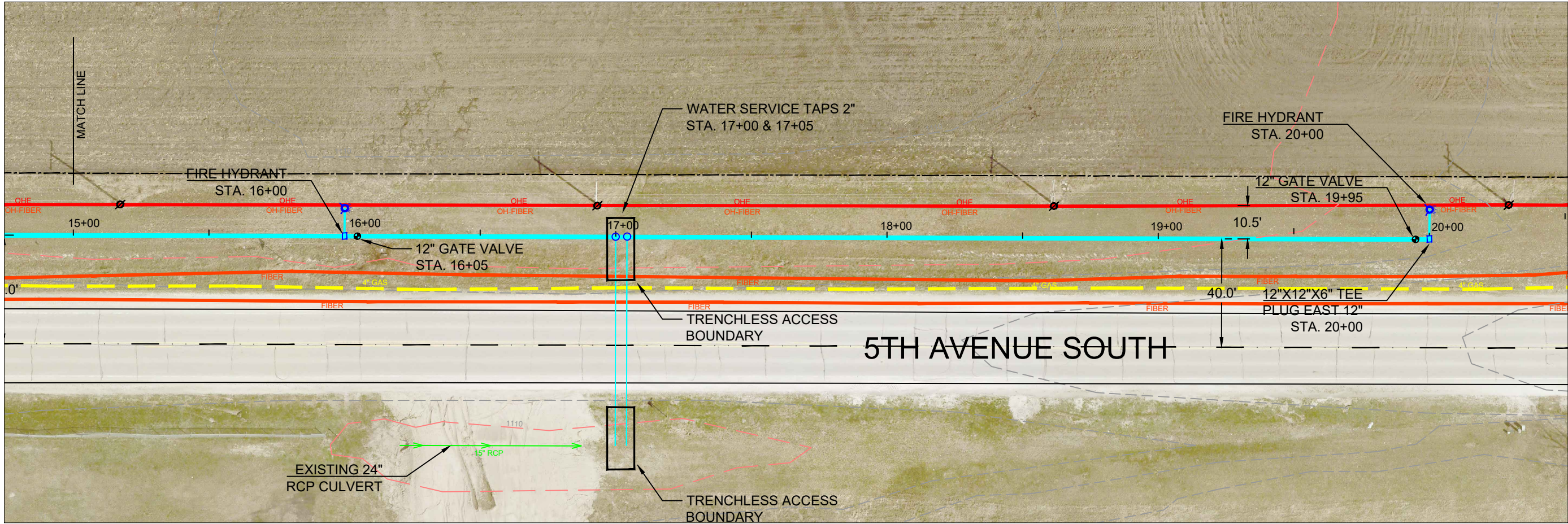

Designed Austin Morrow, PE	Drawn David Odor PLS	Checked Austin Morrow PE	Approved _____	Date _____
2025 5th Avenue South Watermain Extension				
City of Fort Dodge Engineering Department FORT DODGE, IA				
819 1ST AVE S				
Water Plan & Profile				
GENERAL NOTES				
Date: 7-1-2025				
Sheet D.4				